

Please read carefully before installation

## Integrated LED Step Light



### Caution:

- Fixture must be installed in accordance with all local codes
- Fixture should be used "ONLY" with low voltage landscape power units that do not exceed 25A, 15V. The power units reduce the voltage from 120V to 12 volts.
- To avoid electrical shock, disconnect the power unit before installation or service.

### Template of backplate

NO BACKBOX REQUIRED

REMOVABLE LED MODULE

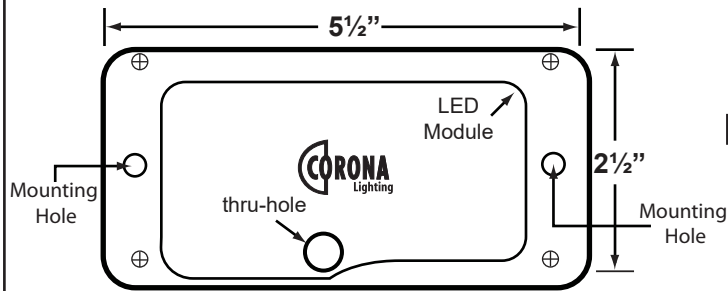

Back view of the fixture and LED Module

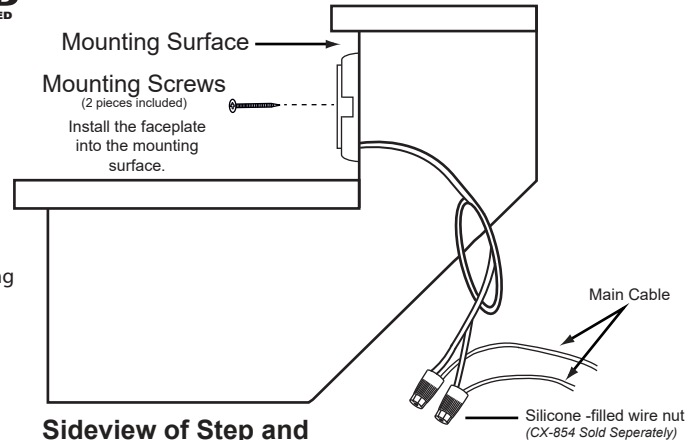

Sideview of Step and Wall Mounting

### INSTALLATION FOR EXISTING STEPS & WALLS:

1. Mark the center of "Thru-Hole" on step or wall. This mark is for drilling to feed fixture wire through step or wall.
2. Make a 1/2" hole on step or wall where center point of "thru-hole" is marked.
3. Line up the "Thru-Hole" with 1/2 hole made in step or wall. Mark the 2 mounting holes on step or wall. Then for concrete, brick or blocks install anchors; for wood applications use mounting screws only.
4. Pull the fixture wire out of step or wall. Install fixture with mounting screws. Verify the "Thru-Hole" is lined up with 1/2 hole made on step or wall.
5. Then connect the fixture wire to main cable by CX-LOC Connector (sold separately). **NOTE:** Always leave about 12" slag of wire behind the mounting surface in order to take the fixture off the mounting surface to replace the defective LED module with new LED module.
6. Provide 12V power source and connect to main cable.

### INSTALLATION FOR NEW CONSTRUCTION STEPS & WALLS:

1. Determine the location of fixture. Run and install one 3/4" conduit at center point of "Thru-Hole" position. Extend the conduit through the structure, so the wire can run through to the rear later.
2. Pour concrete on structure of step or wall. If hole drilling is preferred, complete concrete work and follow the instructions for Installation for Existing Steps & Walls.
3. Cut the 3/4" conduit on fixture side. Line up "Thru-Hole" with 3/4" conduit. Mark the location of two mounting holes on step or wall and install anchors on structure.
4. Pull the fixture wire out of step or wall. Install the fixture with mounting screws. Verify the "Thru-Hole" is lined up with 1/2 hole made on step or wall.
5. Then connect the fixture wire to main cable by CX-LOC Connector (sold separately). **NOTE:** Always leave about 12" slag of wire behind the mounting surface in order to take the fixture off the mounting surface to replace the defective LED module with new LED module.
6. Provide 12V power source and connect to main cable.

Housing- Five (5) year warranty from date of invoice. LED Module- Ten (10) year warranty from date of invoice.

Visit Corona Lighting's Web Site @ [www.coronalighting.com](http://www.coronalighting.com) for complete products information.

Corona Lighting, Inc. ; Los Angeles, California

Mounting Screws and anchors are supplied